

SLURRY PUMPS

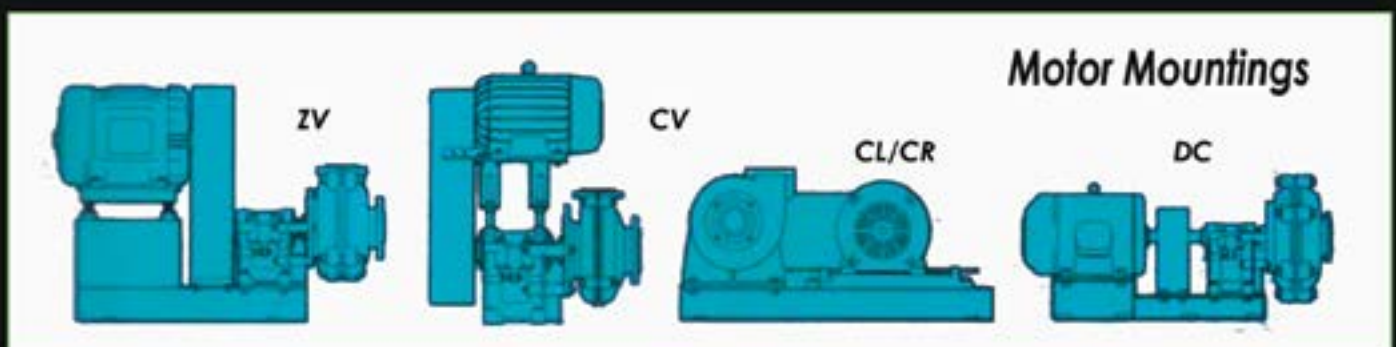

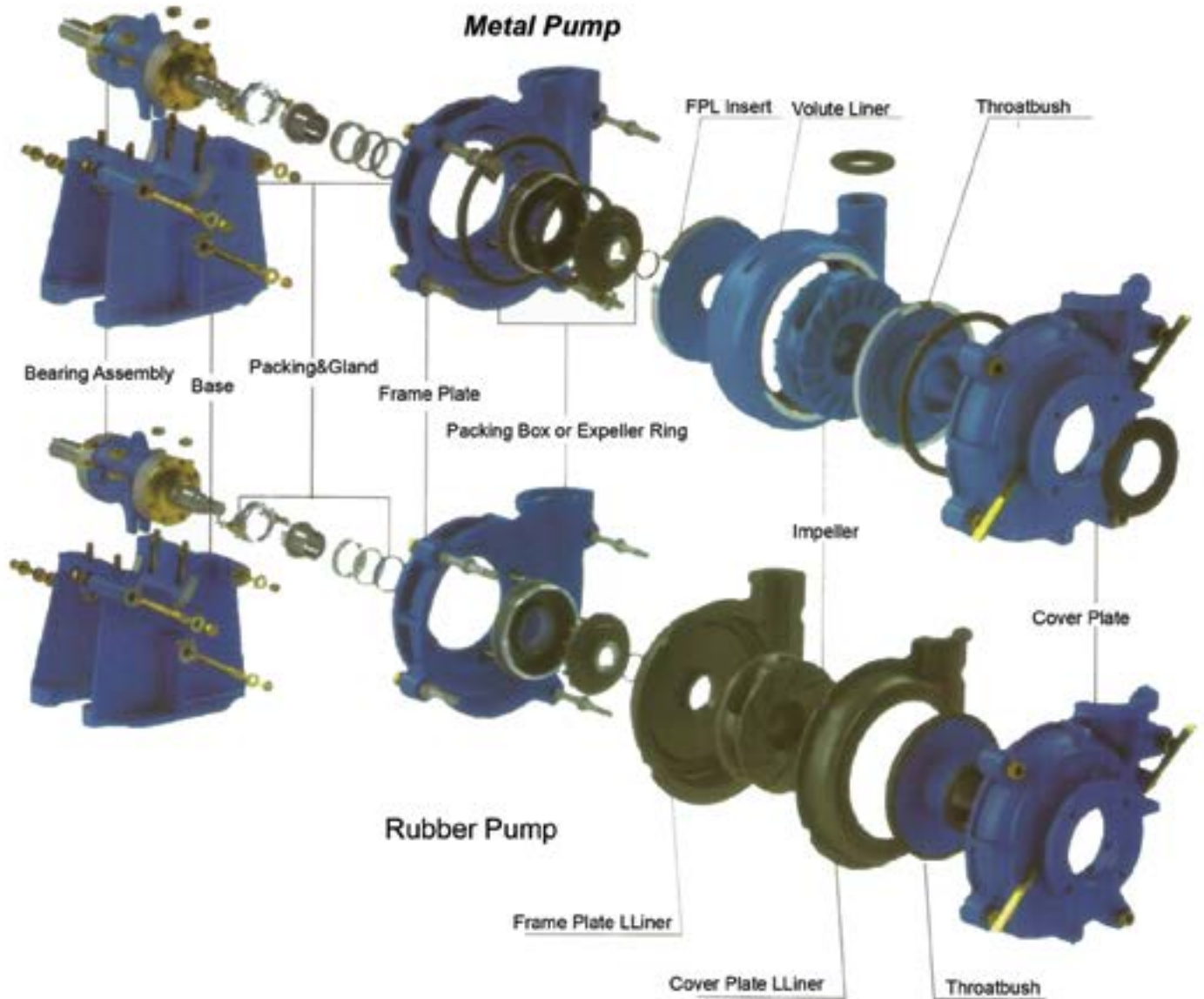

Bearing assembly and shaft

- The shaft is designed with a short overhang to:
 - Reduce-shaft deflection
 - Minimise vibration
- Provided with hardened shaft sleeve to protect the shaft
- Optional dimensionally interchangeable heavy duty bearing assemblies
- Bearing assembly is retained on a one piece frame
- Grease-purged piston rings to help seal contaminants out of bearing housing

Double casing with radial split outer casing

- Ease of assembly and disassembly of liquid end
- Optional construction for higher working pressures
- Removable liners are positively attached with fasteners
- Interchangeable material options

Impeller

- Enclosed impellers to maximise efficiency
- Pump-out vanes on both shrouds
 - Minimises recirculation
 - Reduces stuffing box pressure
- High chrome, ceramic or elastomer liquid ends
- Interchangeable hard metal, ceramic and elastomer impellers
- Impeller clearance set by moving bearing assembly
- High efficiency impeller optional

Removable liner

- Removable high chrome, elastomer, ceramic and tungsten-coated liners can be independently replaced, minimising maintenance costs

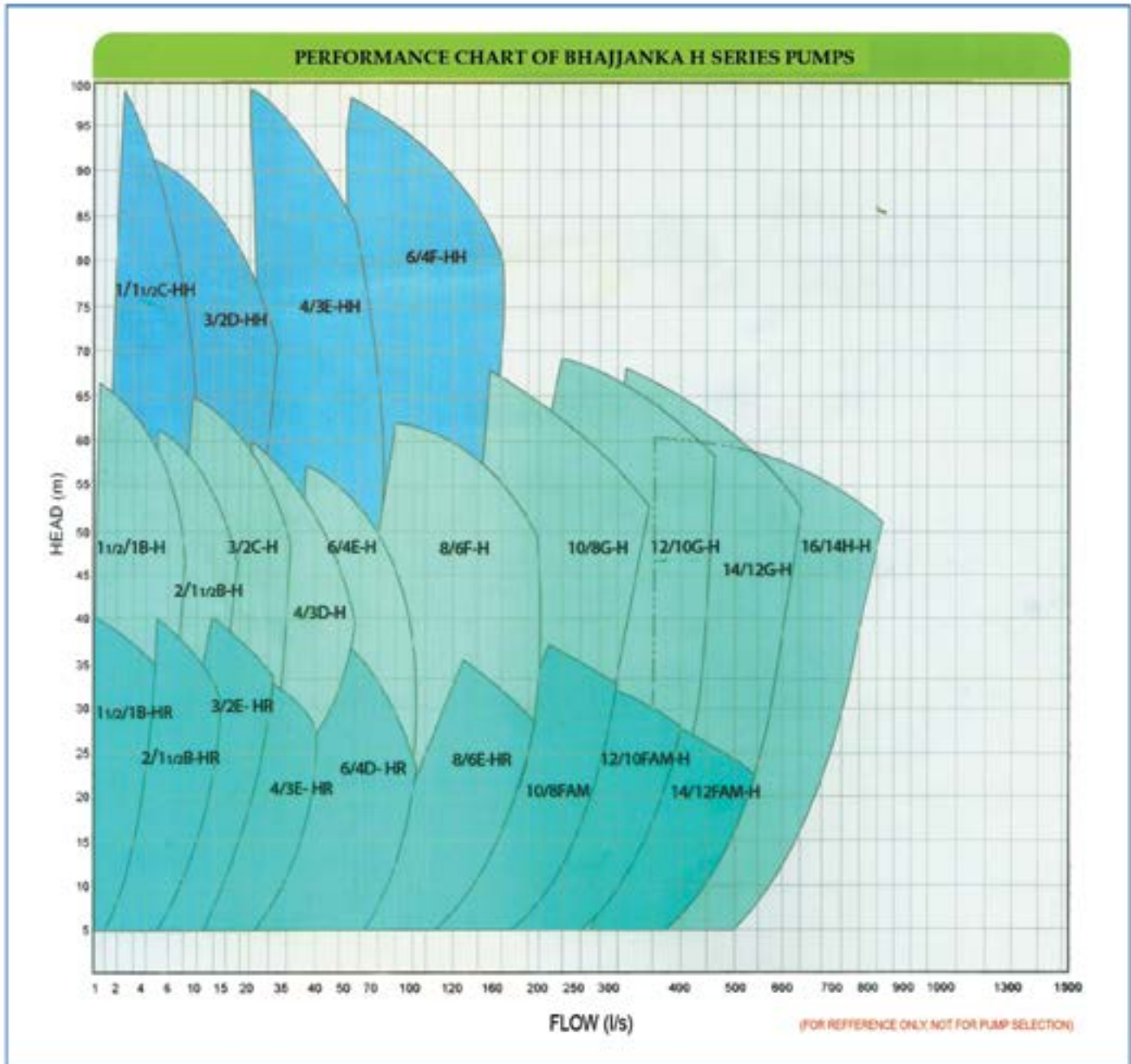

Place to Work:

No visible wear after appr.750 operation hours!

Tungsten Mine Austria

Slightly wear after appr.1.250 operation hours!

Ball Mill Discharge, Kind of Liquid:
Water-Amphibolit-Quartz-Gneis-Mixture
spec.gravity: 1,65 t/m³
Particle size mm: 1mm max.
Capacity: 140 m³/h

All Metal Fit-up

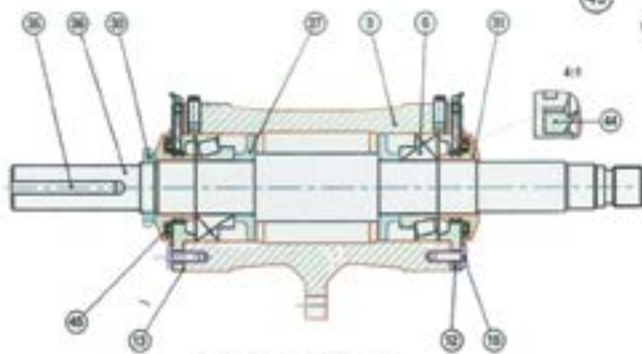
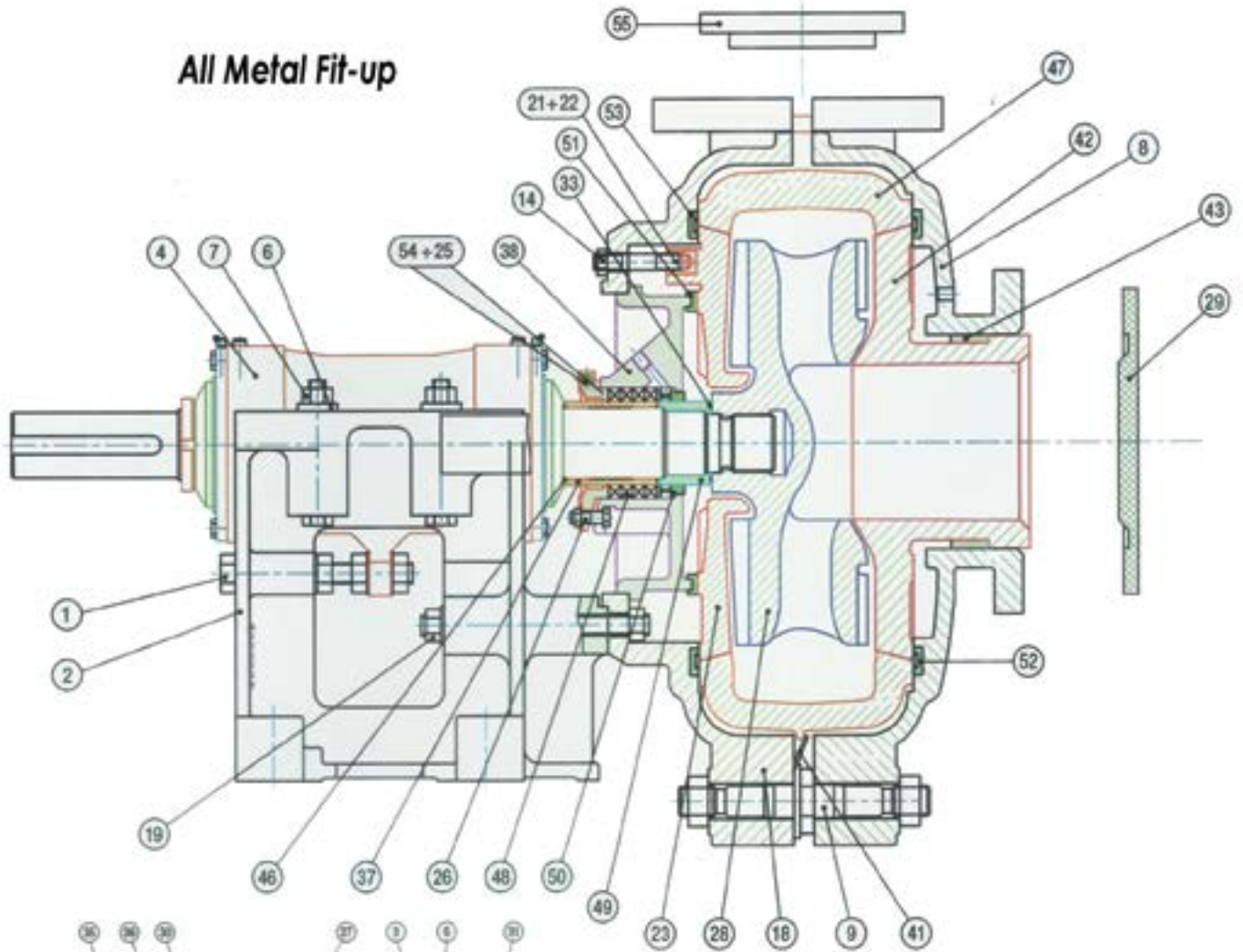

Bearing Assembly

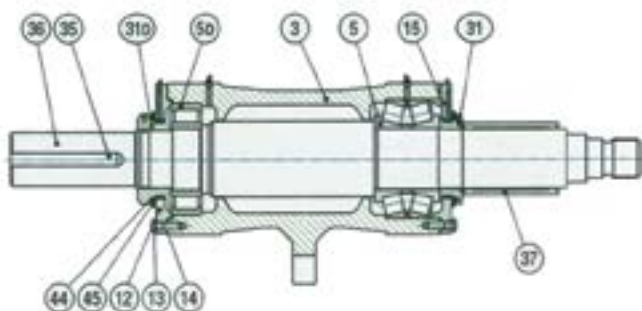

Heavy Bearing Assembly (x)

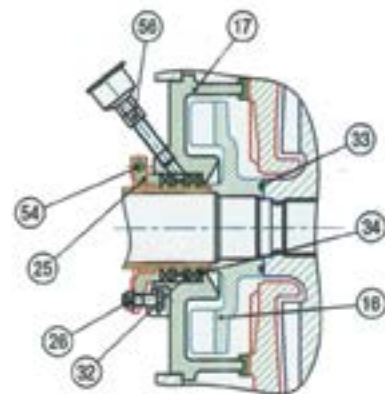
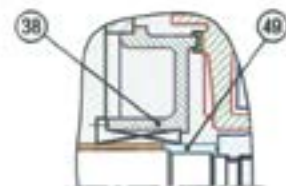

Centrifugal Shaft Seal

All Rubber Fit-up

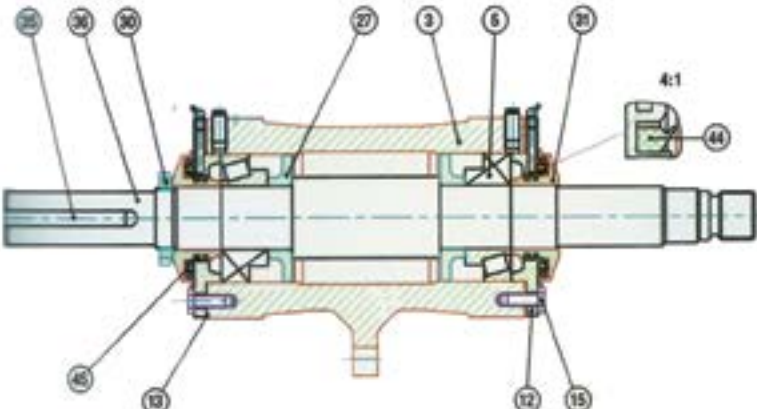
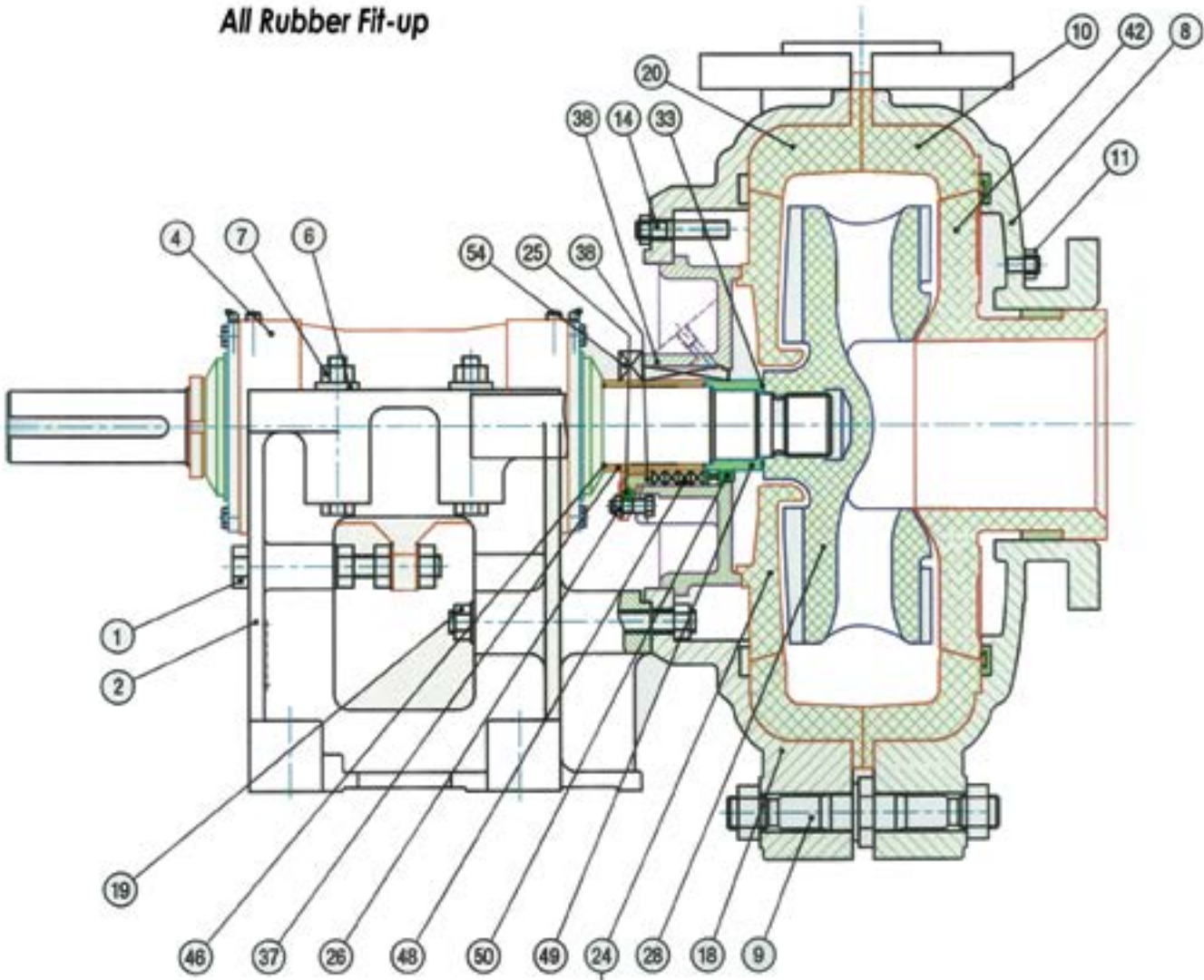

Bearing Assembly

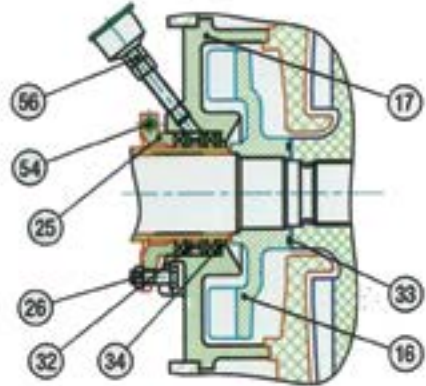

Centrifugal Shaft Seal



Spare parts List

No	DESCRIPTION	Material	Basic No	1,51 B-H	Pos.	1,51 C-HH	Pos.	2/1,5 B-H	Pos.	3/2,C(X)-H	Pos.	3/2,D(X)-HH	Pos.
1	Adjusting Screw	S	001	B 001 M	1	C 001 M	1	B 001 M	1	C 001 M	1	D 001 M	1
2	Base	DIG	003	B 003 M	1	C 003 M	1	B 003 M	1	C 003 M	1	D 003 M	1
3	Bearing Housing	DIG	004	B 004 M	1	C 004 M	1	B 004 M	1	C(X) 004 M	1	D(X) 004 M	1
4	Bearing Assembly	—	005	CAM 005 M	1	C 005 M	1	B 005 M	1	C(X) 005 M	1	D(X) 005 M	1
5	Bearing		006	B 006	2	C 006	2	B 006	2	C(P) 006	2/1	Q 006	1
			006 D	—	—	—	—	—	—	P 006 D	1	Q 006 D	1
6	Clamp Washer	S	011	B 011	4	C 011	4	B 011	4	C 011	4	D 011	4
7	Clamp Bolt and Nut	S	012	B 012 M	4	C 012 M	4	B 012 M	4	C 012 M	4	D 012 M	4
8	Cover Plate	DIG	013	B 1013	1	CH 1013	1	B 15013	1	C 2013	1	DH 2013	1
9	Cover Plate Bolt	S	015	B 015 M	4	C 015 M	6	B 015 M	4	C 015 M	4	E 4015	6
10	Cover Plate Liner	R	017/018	B 1017	1	—	—	B 15017	1	C 2017	1	—	—
11	Cover Plate Liner Stud	S	023	—	—	—	—	—	—	C 023 M	2	—	—
12	End Cover		024	B 024-10	2	C 024-10	2	B 024-10	2	CO(X) 024-10	2/1	D(X) 024-10	2/1
			024 D	—	—	—	—	—	—	CX 024 D-10	1	DX 024 D-10	1
13	Shim Set	S	025	B 025	2	C 025	2	B 025	2	CO(X) 025	2	DOD 025	2
14	Frame Plate Liner Insert Stud	S	026	B 026 M	3	—	—	B 026 M	3	C 026 M	4	DAM 026M	4
15	End Cover Set Screw	S	027	B 027 M	8	B 027 M	8	B 027 M	8	B 027 M	8	D 027 M	8
16	Expeller	A 1	028	B 028	1	CH 028	1	B 028	1	C 028	1	DAM 028	1
17	Expeller Ring	A 1	029	B 029	1	CH 029	1	B 029	1	C 029	1	DAM 029	1
18	Frame Plate	DIG	032	B 1032	1	CH 1032	1	B 15032	1	C 2032	1	DH 2032	1
19	Frame Plate Bolt	S	034	—	—	—	—	—	—	—	—	DH 034 M	3
20	Frame Plate Liner	R	036	B 1036	1	—	—	B 15036	1	C 2036	1	—	—
21	Frame Plate Liner Stud	S	039	B 039 M	3	C 039 M	3	B 039 M	3	C 039 M	3	—	—
22	Frame Plate Liner Insert Bolt	S	040	—	—	CH 040 M	4	—	—	—	—	DH 040	4
23	Frame Plate Liner Insert	A	041	B 1041	1	CH 1041	1	B 15041	1	C 2041	1	DH 2041	1
24	Frame Plate Liner	R	043	—	—	—	—	—	—	—	—	—	—
25	Wand	D	044	B 044	1	CH 044	1	B 044	2	C 044	1	D 044	1
26	Gland Bolt	S	045	B 045 M	2	C 045 M	2	B 045 M	2	C 045 M	2	D 045 M	2
27	Grease Retainer	D	046	B 046	2	C 046	2	B 046	2	C 046	2	D 046	2
28	Impeller	A/R	Various	B 1127/1052	1	CH 1127	1	B 15127	1	C2147Q7	1	DH 2147	1
29	Intake Joint Ring	R	060	B 1060	1	CH 1060	1	B 15060	1	C 2060	1	C 2060	1
30	Labyrinth Lockout & Washer	S	061	B 061	1	C 061	1	B 061	1	C 061	1	—	—
31	Labyrinth		062	B 062-10	2	C 062-10	2	B 062-10	2	C(X) 062-10	2/1	D(X) 062-10	2/1
			062 D	—	—	—	—	—	—	CX 062D-10	1	DX 062D-10	1
32	Lantern Ring	S1	063	B 063	1	CH 063	1	B 063	1	C 063	1	D 063	1
33	Impeller Sealing O. Ring	R	064	B 217	1	—	—	B 217	1	C 217	1	F 064	1
34	Neck Ring	S 1	067	B 067	1	CH 067	1	B 067	1	C 067	1	D 067	1
35	Pulley Key	S	070	B 070	1	—	—	B 070	1	C 070	1	—	—
36	Shaft	S	073	B 073 M	1	CAM 073 M	1	B 073 M	1	CO(X) 073 M	1	D(X)AM 073 M	1
37	Shaft Sleeve	S	075/076	B 075 1	1	CH 075	1	B 075	1	C 075	1	D 075	1
38	Stuffing Box	A/DIG 2	078	B 078	1	CH 078	1	B 078	1	C 078	1	DH 078	1
42	Throatbush	A/R	083	—	—	—	—	—	—	—	—	DH 2083	1
43	Throatbush Cotter	S	085	—	—	—	—	—	—	—	—	EH 3085	1
44	Bearing Seal	R	089 / 090	B 090	2	—	—	B 090	2	C(X) 089-10	2	D(X) 089-10	2
45	45 Piston Ring		106	B 106	4	C 106	4	B 106	4	C 106	4	D 106	4
			106 X	—	—	—	—	—	—	P 106	4	—	—
46	Shaft O. Ring	R	109	B 109	2	CH 109	2	B 109	2	C 109	2	D 109	2/3
47	Valve Liner	A	110	B 1110	1	CH 1110	1	B 15110	1	C 2110	1	DH 2110	1
48	Packing Ring		111	B 111	2/4	CH 111	3/7	B 111	2/4	C 111	2/4	D 111	2/4
49	Shaft Spacer	S 2	117	B 117	1	—	—	B 117	1	C 117	1	DAM 117	1
50	Lantern Resistor	S2	118	B 118	1	CH 118	1	B 118	1	C 118	1	D 118	1
51	Expeller Ring Seal	R	122	B 122	1	CH 122	1	B 122	1	C 122	1	EP 122	1
52	Valve Cover Seal	R	124	—	—	—	—	—	—	—	—	—	—
53	Valve Frame Seal	R	125	B 1125	1	CH 1125	1	B15125	1	C 2125	1	DH 2125	2
54	Gland Clamp Bolt	S	128	B 128 M	2	C 128 M	2	B 128 M	2	C 128 M	2	D 128 M	2
55	Joint Ring Discharge	R	132	B 1132 L	1	B 1132 H	1	B15132L	1	C 2132 L	1	C 2132 H	1
56	Grease Cup Adaptor	—	136	B 136	1	D136	1	B136	1	D136	1	D136	1

Spare parts List

43,C-H	Pcs	43,E,HH	Pcs	64,D-H	Pcs	64,F(X)-H	Pcs	86,EX)-H	Pcs	108,EX)-H	Pcs	12/10,EX)-H	Pcs	14/12,EX)-H	Pcs	No
C 001 M	1	E 001 M	1	D 001 M	1	F 001 M	1	E 001 M	1	F 001 M	1	F 001 M	1	F 001 M	1	1
C 003 M	1	E 003 M	1	E 003 M	1	F 003 M	1	E 003 M	1	FAM 003 M	1	FAM 003 M	1	FAM 003 M	1	2
C(X) 004 M	1	E(X) 004 M	1	D(X) 004 M	1	F(X) 004 M	1	E(X) 004 M	1	F(X) 004 M	1	F(X) 004 M	1	ND 004 M	1	3
C(X)AM 005 M	1	E(X)AM 005 M	1	D(X) 005 M	1	F(X)AM 005 M	1	E(X) 005 M	1	F(X) 005 M	1	F(X) 005 M	1	F(X) 005 M	1	4
GP) 009	2/1	R 009	1	D(Q) 009	2/1	S 009	1	C(R) 009	2/1	F(S) 009	2/1	F(S) 009	2/1	F(S) 009	2/1	5
P 009 D	1	R 009 D	1	Q 009 D	1	S 009 D	2	R 009 D	1	S 009 D	2	S 009 D	2	S 009 D	2	
C 001	4	E 011	4	D 011	4	F 011	4	E 011	4	F 011	4	F 011	4	F 011	4	6
C 012 M	4	E 012 M	4	D 012 M	4	FM 012 M	4	ED 12 M	4	F 012 M	4	F 012 M	4	F 012 M	4	7
D 3013	1	EH 3013	1	E 4013	1	FH 4013	1	F 8013	1	G 8013	1	G 10013	1	G 12013	1	8
D 015 M	4	EH 3015 M	6	E 4015 M	4	G 8015 M	3	F 8015 M	6	G 8015 M	8	G 10015 M	8	G 12015 M	8	9
D 3017	1	---	---	E 4018	1	---	---	F 8018	1	G 8018	1	G 10018	1	G 12018	1	10
D 023 M	2	---	---	---	---	---	---	---	---	---	---	---	---	---	---	11
C(X) 024-10	2/1	E(X) 024-10	2/1	D(X) 024-10	2/1	F(X) 024-10	2	E(X) 024-10	2/1	F(X) 024-10	2	F(X) 024-10	2	F(X) 024-10	2	12
C(X) 024 D-10	1	E(X) 024 D-10	1	D(X) 024 D-10	1	---	---	E(X) 024 D-10	1	---	---	---	---	---	---	
C(X) 025	2	E(X) 025	2	D(X) 025	2	F(X) 025	2	E(X) 025	2	F(X) 025	2	F(X) 025	2	F(X) 025	2	13
C 026 M	4	---	---	DAM 026 M	4	FH 4026 M	4	E 10026 M	4	---	---	---	---	---	---	14
B 027 M	8	D 027 M	16	D 027 M	8	F 027 M	16	D 027 M	8	F 027 M	16	F 027 M	16	F 027 M	16	15
D 028	1	EAM 028	1	DAM 028	8	FH 028	1	EAM 028	1	G 028	1	G 028	1	G 028	1	16
CAM 029	1	EAM 029	1	DAM 029	1	FH 029	1	EAM 029	1	G 029	1	G 029	1	G 029	1	17
CAM 3032	1	EH 3032	1	DAM 4032	1	FH 4032	1	EAM 4032	1	G 8032	1	G 10032	1	G 12032	1	18
---	---	E 034 M	3	D 034 M	3	---	---	E 034 M	3	---	---	---	---	---	---	19
D 3036	1	---	---	E 4036	1	---	---	F 8036	1	G 8036	1	G 10036	1	G 12036	1	20
C 039 M	3	---	---	---	---	FH 039 M	3	---	---	FAM 039 M	3	FAM 039 M	3	FAM 039 M	3	21
---	---	F 8040	4	---	---	---	---	E 10026 M	4	G 8026 M	4	G 8026 M	4	G 8026 M	4	22
D 3041	1	EH 3041	1	E 4041	1	FH 4041	1	F 8041	1	G 8041	1	G 10041	1	G 12041	1	23
---	---	---	---	---	---	---	---	---	---	---	---	---	G 12043	1	24	
C 044	1	E 044	1	D 044	1	F 044	1	E 044	1	G 044	1	G 044	1	G 044	1	25
C 045 M	2	E 045 M	2	D 045 M	2	F 045 M	2	E 045 M	2	G 045 M	2	G 045 M	2	G 045 M	2	26
C 046	2	E 046	2	D 046	2	F 046	2	E 046	2	F 046	2	F 046	2	F 046	2	27
D 3147	1	EH 3147	1	E 4147	1	FH 4147 A	1	F 8147	1	FAM 8147	1	FAM 10147	1	FAM 12147	1	28
D 3060	1	EH 3060	1	E 4060	1	FH 4060	1	F 8060	1	G 8060	1	G 10060	1	G 12060	1	29
C 061	1	E 061	1	D 061	1	F 061	1	E 061	1	F 061	1	F 061	1	F 061	1	30
C(X) 062 - 10	2/1	E(X) 062-10	2/1	D(X) 062-10	2/1	F(X) 062-10	2/1	E(X) 062-10	2/1	F(X) 062-10	2/1	F(X) 062-10	2/1	FX 0620-10	2/1	31
CX 062 D -10	1	EX 062D-10	1	DX 062D-10	1	FX 062D-10	1	EX 062D-10	1	FX 062D-10	1	FX 062D-10	1	FX 062D-10	1	
C 063	1	E 063	1	D 063	1	E 063	1	---	---	G 063	1	G 063	1	G 063	1	32
D 064/ E 064	1	F 064	1	F 064	---	---	---	F 064	1	---	---	---	---	---	---	33
C 067	1	E 067	1	D 067	1	---	---	E 067	1	G 067	1	G 067	1	G 067	1	34
---	---	E 070	1	D 070	1	F 070	1	E 070	1	F 070	1	F 070	1	F 070	1	35
C(X) 069 - 10	2	E(X)AM 073 M	1	D(X) 073 M	1	F(X)AM 073 M	1	E(X) 073 M	1	F(X) 073 M	1	F(X) 073 M	1	F(X) 073 M	1	36
C 075	1	E 075	1	D 075	1	F 075	1	E 075	1	FAM 075	1	FAM 075	1	FAM 075	1	37
CAM 078	1	EH 078	1	DAM 078	1	FH 078	1	EAM 078	1	---	---	---	---	---	---	38
---	---	EH 3083	1	E 4083	1	FH 4083	1	F 8083	1	G 8083	1	G 10083	1	G 12083	1	42
---	---	EH 3085	2	E 4085	2	E 4085	2	F 8085	2	F 8085	2	G 10085	2	G 10085	2	43
C(X) 089 - 10	2	E X 089-10	2	D(X) 089-10	2	F(X) 089-10	2	E(X) 089-10	2	F(X) 089-10	2	F(X) 089-10	2	F(X) 089-10	2	44
C 108	4	E 108	4	D 108	4	F 108	4	E 108	4	F 108	4	F 108	4	F 108	4	45
P 108	4	R 108	4	YC 108	4	YE 108	4	R 108	4	YE 108	4	YE 108	4	YE 108	4	
C 109	2	E 109	2	D 109	2	F 109	4	E 109	2	G 109	3	G 109	3	G 109	3	46
D 3190	1	EH 3190	1	E 4190	1	FH 4190	1	F 8190	1	G 8190	1	G 10190	1	G 12190	1	47
C 111	2/4	E 111	2/4	D 111	2/4	F 111	2/4	E 111	2/4	G 111	2/4	G 111	2/4	G 111	2/4	48
CAM 117	1	EMA 117	1	DAM 117	1	FG 117	1	EAM 117	1	FAM 117	1	FAM 117	1	FAM 117	1	49
C 118	1	E 118	1	D 118	1	F 118	1	E 118	1	F 118	1	F 118	1	F 118	1	50
C 122	1	F 122	1	E 122	1	FH 122	1	F 122	1	G 122	1	G 122 1	1	G 122	1	51
---	---	F 8124	2	E 4124	2	G 8124	2	F 8124	2	G 8124	2	G 10124	2	G 12124	2	52
D 3125	1	---	---	---	---	---	---	---	---	---	---	---	---	---	---	53
C 126 M	2	E 126 M	2	D 126 M	2	E 126 M	2	E 126 M	2	G 126 M	2	G 126 M	2	G 126 M	2	54
D 3132 L	1	EH 3132 H	1	E 4132	1	E 4132 H	1	F 8132 L	1	G 8132 L	1	G 10132 L	1	G 12132 L	1	55
D 138	1	D 138	1	D 138	1	D 138	1	---	---	---	---	---	---	---	---	56
D 789	1	---	---	D 789	1	---	---	E 789	1	---	---	F 789	1	F 789	1	

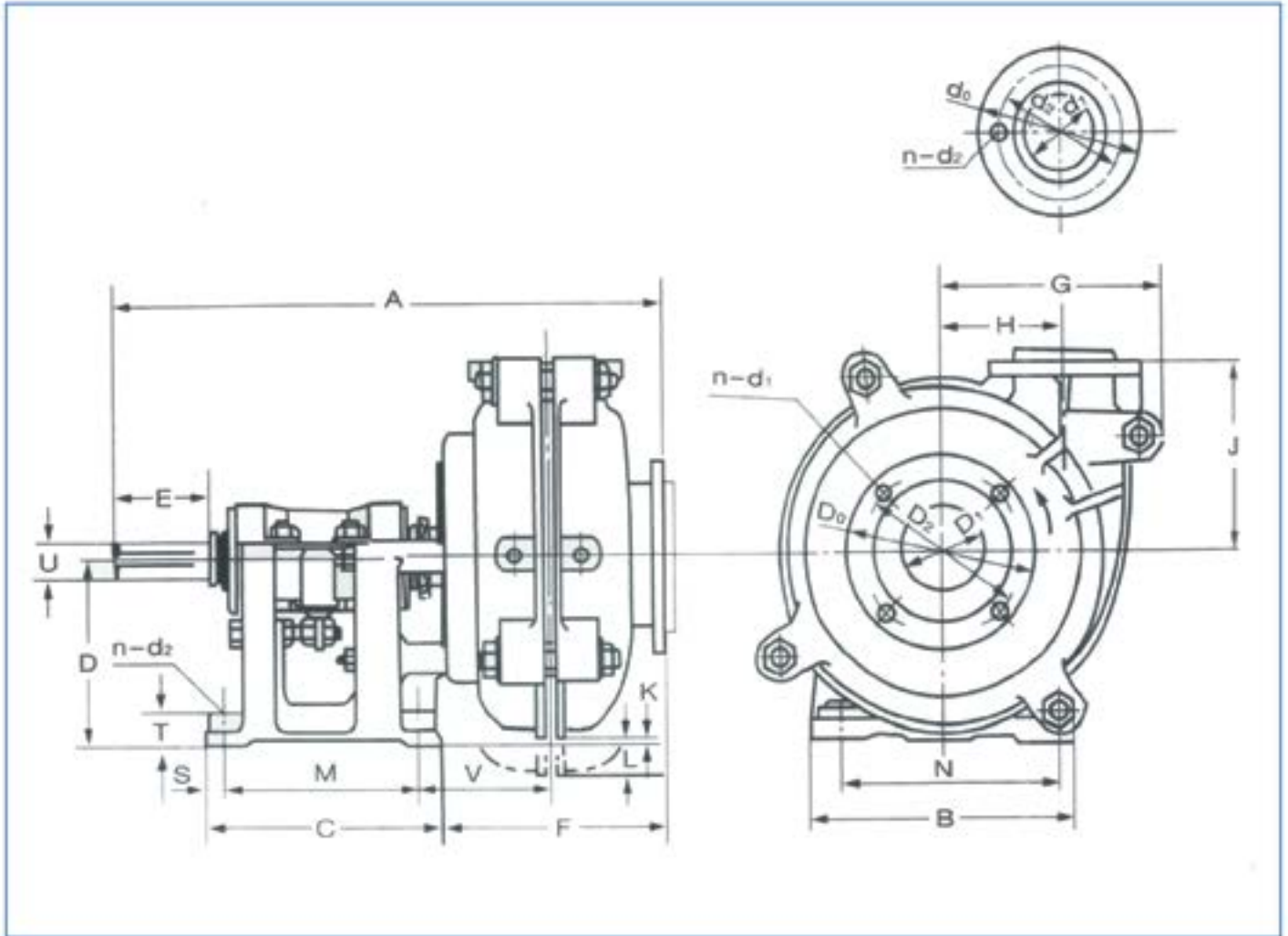

No	Type	A	B	C	D	U	E	F	G	H	J	K	L	M	N	V
1	1 1/2 I B-H	583	295	248	197	28	79	206	181	98	171	46	----	143	254	181
2	1 1/2 I C-HH	759	406	311	254	42	121	306	270	194	254	----	11	175	356	252
3	2 1/2 I B-H	592	295	248	197	28	79	217	205	114	184	33	----	143	254	184
4	3/2 C(X)-H	768	406	311	254	42 (45)	121	281	238	138	210	71	----	175	356	233
5	3/2 D-H	986	492	364	330	65	164	389	384	254	368	----	51	213	432	298
6	4/3 C(X)-H	843	406	311	254	42 (45)	121	354	292	149	262	24	----	175	356	270
7	4/3 D-H	943	492	364	330	65	164	353	292	149	262	100	----	213	432	279
8	4/3 E-H	1240	622	448	457	80	222	492	492	330	432	----	----	257	546	381
9	6/4 D(X)-H	1021	492	364	330	65 (60)	164	421	406	229	338	11	----	213	432	318
10	6/4 E-H	1178	622	448	457	80	222	433	406	229	338	138	----	257	546	351
11	6/4 E-HH	1556	857	635	610	108	279	584	616	403	546	----	----	349	762	280
12	8/6 E(X)-H	1302	622	448	457	80 (85)	222	557	551	318	460	----	62	257	546	402
13	8/6 R-H	1360	680	590	350	85	215	----	511	318	460	----	170	490	560	312
14	10/8 E-HM	1337	622	448	457	80	222	584	613	381	470	----	83	257	546	403
15	10/8 R-HM	1395	680	590	350	85	215	----	613	381	470	----	190	490	560	314
16	10/8 F-H	1635	990	635	610	100	279	584	673	419	635	----	----	349	762	280
17	12/10 F-H	1725	990	635	610	100	279	584	655	464	674	----	----	349	762	200
18	14/12 F-H	1755	990	635	610	100	279	584	937	429	832	----	----	349	762	280
19	16/14 G-H	2189	1206	876	850	140	356	953	1048	660	889	----	----	749	850	502

Pumps & Dimensions



T	S	n-d	SUCTION FLANGE				PRESSURE FLANGE				Weight (kg)		
			D ₀	D ₁	D ₂	n-d ₁	d ₀	d ₁	d ₂	n-d ₂	Metal	Rubber	NO
38	24	4 - ø 14	152	38	114	4 - 16	165	25	127	4 - ø 16	91	77	1
48	32	4 - ø 19	152	38	114	4 - 17	152	25	114	4 - ø 17	318	---	2
38	24	4 - ø 14	184	51	146	4 - 19	165	38	127	4 - ø 19	104	88	3
48	32	4 - ø 19	216	76	178	4 - 19	184	51	146	4 - ø 19	191	154	4
64	38	4 - ø 22	216	76	178	8 - 19	203	51	165	4 - ø 19	750	---	5
48	32	4 - ø 19	279	102	235	4 - 22	229	76	191	4 - ø 22	263	236	6
64	38	4 - ø 22	279	102	235	4 - 22	229	76	191	4 - ø 22	363	290	7
76	54	4 - ø 29	254	102	210	8 - 19	254	76	210	8 - ø 19	1250	---	8
64	38	4 - ø 22	337	152	292	4 - 22	279	102	235	4 - ø 22	626	454	9
76	54	4 - ø 29	337	152	292	4 - 22	279	102	235	4 - ø 22	728	635	10
98	95	4 - ø 35	337	152	292	8 - 22	305	102	260	8 - ø 22	2529	---	11
76	54	4 - ø 29	406	203	356	8 - 22	368	152	324	8 - ø 21	1473	982	12
70	50	4 - ø 28	406	203	356	8 - 22	368	152	324	8 - ø 22	1655	---	13
76	54	4 - ø 29	502	254	445	8 - 29	432	203	375	8 - ø 29	1625	1202	14
70	50	4 - ø 28	502	254	445	8 - 29	432	203	375	8 - ø 29	1836	---	15
98	95	4 - ø 35	502	254	445	8 - 29	432	203	375	8 - ø 29	3750	3130	16
98	95	4 - ø 35	527	305	470	12 - 25	527	254	470	12 - ø 25	4318	3357	17
98	95	4 - ø 35	585	356	521	12 - 25	552	305	495	12 - ø 25	6409	4672	18
152	63	4 - ø 41	705	406	641	12 - 35	673	356	610	12 - ø 29	10000	---	19



Bhajjanka

Fluid Control Expert

SLURRY PUMPS

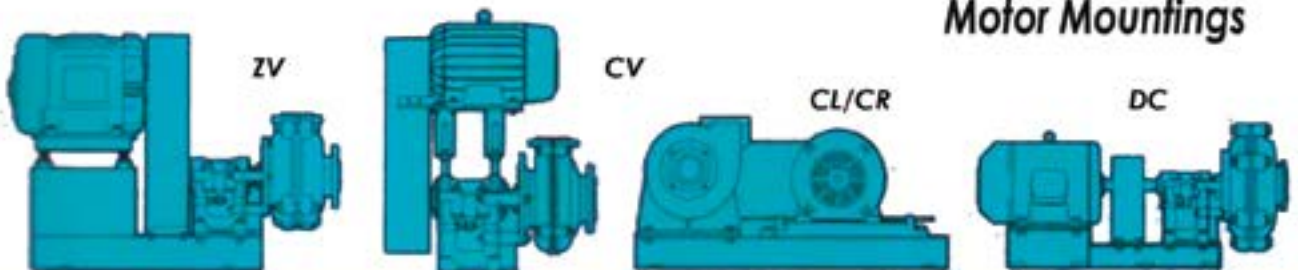

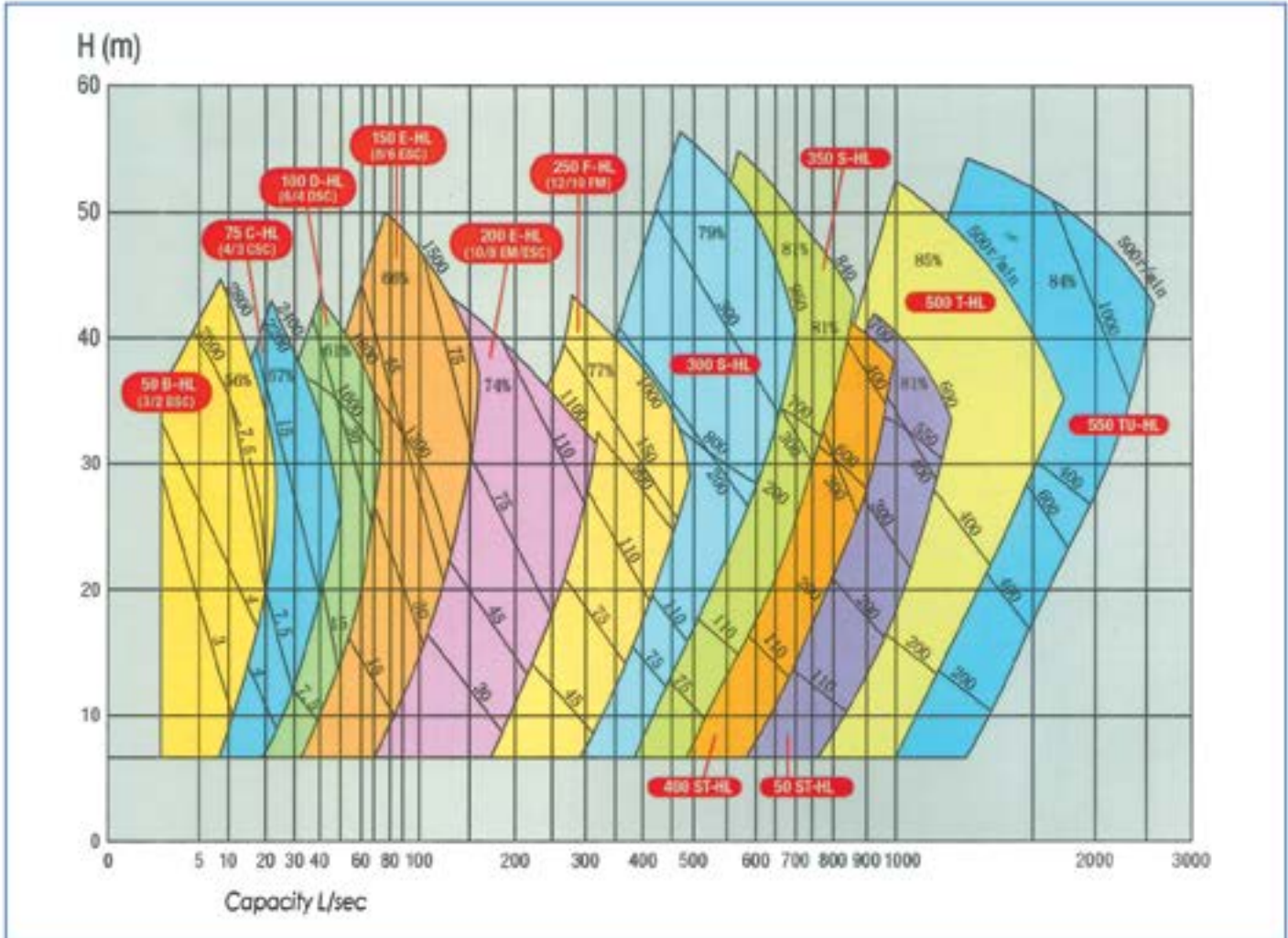

Possible Discharge
Flange positions



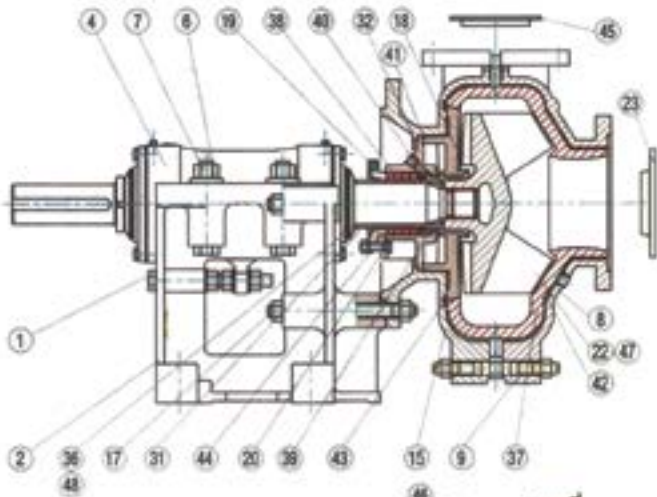

400 ST-HL 650 TU-HL

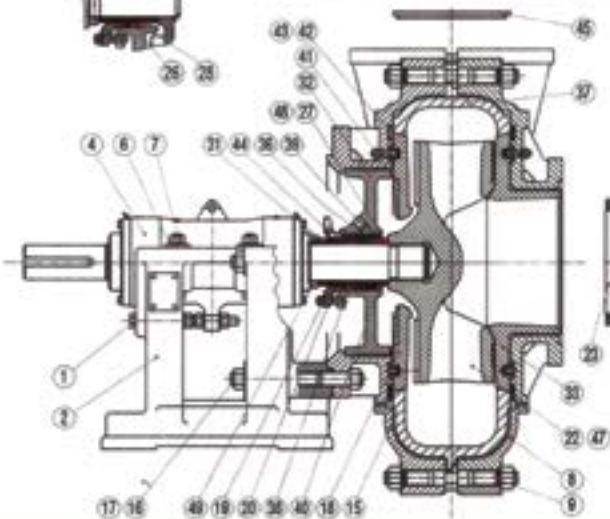
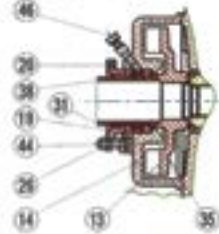

Bearing Assembly

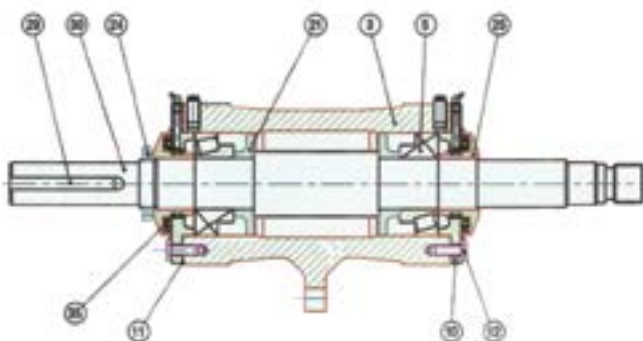

No.	DESCRIPTION	Material	Basic No.
1	Adjusting Screw	S	001
2	Base	D/G	003
3	Bearing Housing	D/G	004
4	Bearing Assembly	-	005
5	Bearing	-	009
		-	009 D
6	Clamp Washer	S	011
7	Clamp Bolt and Nut	S	012
8	Cover Plate	D/G	013
9	Cover Plate Bolt	S	015
10	End Cover	D/G	024
11	End Cover Shim	S	025
12	End Cover Set Screw	S	027
13	Expeller	A 1	028
14	Expeller Ring	A 1	029
15	Adaptor Plate	D/G	032
16	Frame Plate Bolt	S	034
17	Frame Plate Stud	S	039
18	Frame Plate Liner Insert	A/R	041
19	Gland	D	044
20	Gland Bolt	S	045
21	Grease Retainer	D	046
22	Impeller - 8 Vane	-	053
	Impeller - 4 Vane	-	056
23	Intake Joint Ring	R	060
24	Labyrinth Locknut & Washer	S	061
25	Labyrinth	S	062
		S	062 DM
26	Lantern Ring	S 1	063
27	Impeller >>O<<Ring	R	064
28	Neck Ring	S 1	067
29	Pulley Key	S	070
30	Shaft	S	073
31	Shaft Sleeve	S	075
32	Stuffing Box	A/D/G2	078
33	Throatbush	A	083
34	Bearing Seal	-	089
35	Piston Ring	G	108
36	Shaft >>O<< Ring	R	109
37	Volute Liner	A	110
38	Packing Ring	-	111
39	Shaft Spacer	S 2	117
40	Lantern Restrictor	S 2	118
41	Expeller Ring Seal	R	122
42	Volute Cover Seal	R	124
43	Back Liner Seal	R	124
44	Gland Clamp Bolt	R	126
45	Discharge Joint Ring	R	132
46	Grease Cup Adaptor	-	138
47	Impeller	-	147
48	>>O<< Ring	R	210
49	Release Collar Assy.	S	239

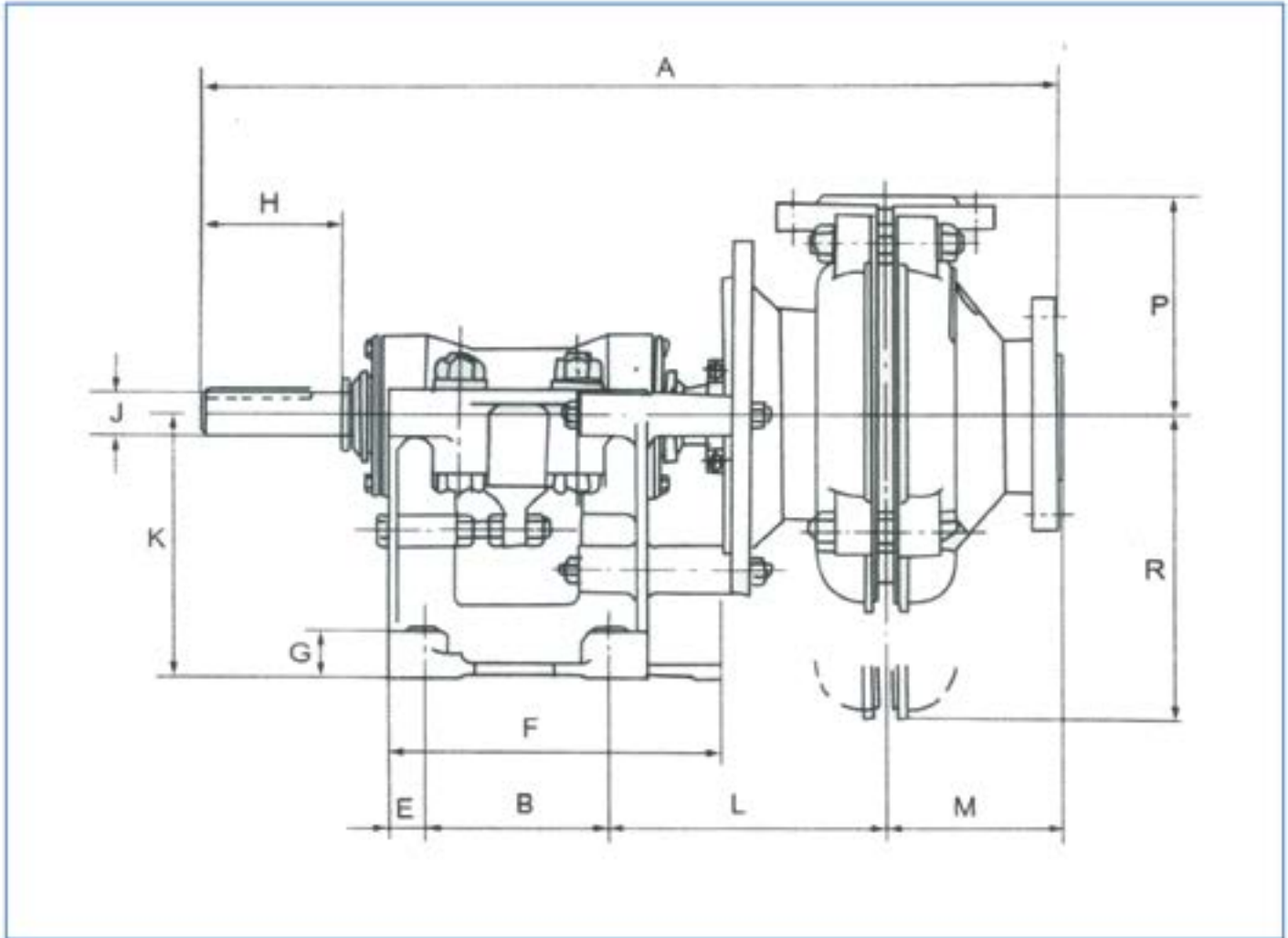

No	Model	Old description	A	B	C	D	E	F	G	n-d	H	J	K	L	M
1	20 A-HL(R)	-	461	159	241	286	25	210	28	4 - ϕ 18	57	20	145	89	90
2	50 B-HL(R)	3/2 BSC	624	143	254	295	24	248	38	4 - ϕ 14	80	28	197	191	136
3	75 C-HL(R)	4/3 CSC	813	175	356	406	32	311	48	4 - ϕ 19	120	42	254	253	163
4	100 D-HL(R)	6/4 DSC	950	213	432	492	38	346	64	4 - ϕ 22	163	65	330	280	187
5	150 E-HL(R)	8/6 ESC	1218	257	546	622	54	448	76	4 - ϕ 29	220	80	457	376	237
6	200 E-HL(R)	10/8 ESC	1334	257	546	622	54	448	76	4 - ϕ 29	220	80	457	413	306
7	250 E-HL(R)	-	1348	257	546	622	54	448	76	4 - ϕ 29	220	80	457	411	324
8	250 R-HL(R)	-	1406	490	560	680	50	590	70	4 - ϕ 28	216	85	350	322	324
9	300 S-HL(R)	-	1720	640	760	920	70	780	90	4 - ϕ 35	280	120	450	415	300
10	350 S-HL(R)	-	1776	640	760	920	70	780	90	4 - ϕ 35	280	120	450	425	340

Pumps & Dimensions

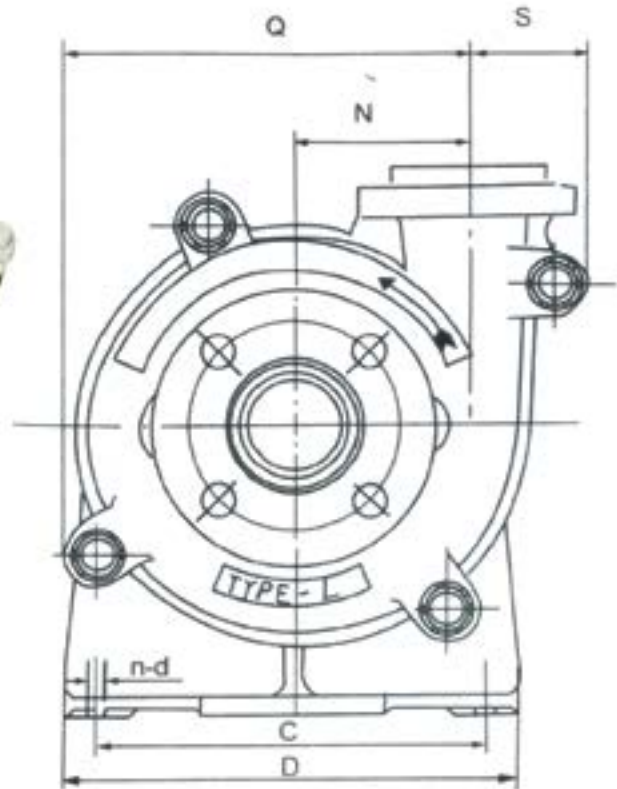
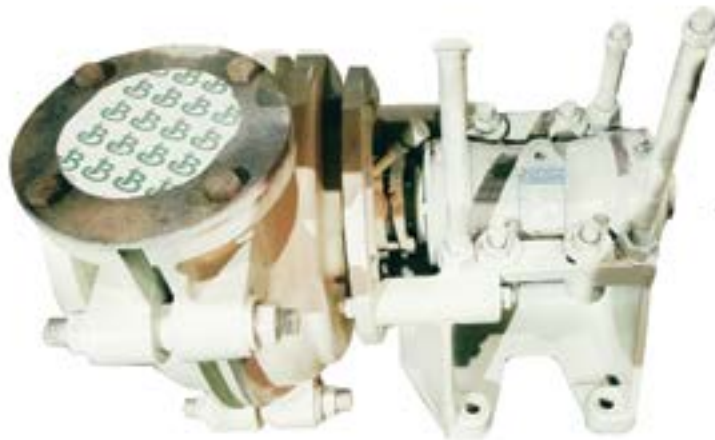

PUMPS MAIN DIMENSIONS					SUCTION FLANGE				PRESSURE FLANGE				No.
N	S	Q	R	P	O.D.	L.D.	C-C Bet. Holes	Hole	O.D.	L.D.	C-C Bet. Holes	Hole	
86	144	-	-	128	114	25	83	4 - Ø14	102	20	73	4 - Ø14	1
114	-	155	-	163	184	75	146	4 - Ø19	165	50	127	4 - Ø19	2
146	102	-	-	204	229	100	191	4 - Ø19	203	75	165	4 - Ø19	3
190	118	-	-	262	305	150	260	4 - Ø22	229	100	191	4 - Ø22	4
248	155	-	-	324	368	200	324	4 - Ø19	305	150	260	4 - Ø19	5
292	199	-	-	401	445	250	394	4 - Ø22	382	200	337	4 - Ø22	6
438	257	476	603	470	552	305	495	4 - Ø32	483	254	425	4 - Ø32	7
438	257	476	603	470	552	305	495	4 - Ø32	483	254	425	4 - Ø32	8
475	265	599	634	570	560	350	500	4 - Ø26	530	300	470	4 - Ø26	9
530	295	643	691	620	640	400	580	4 - Ø26	590	350	530	4 - Ø26	10

ORIGINAL PLANT IMAGES

